

# THE DARWIN GREEN COLOUR FIELD

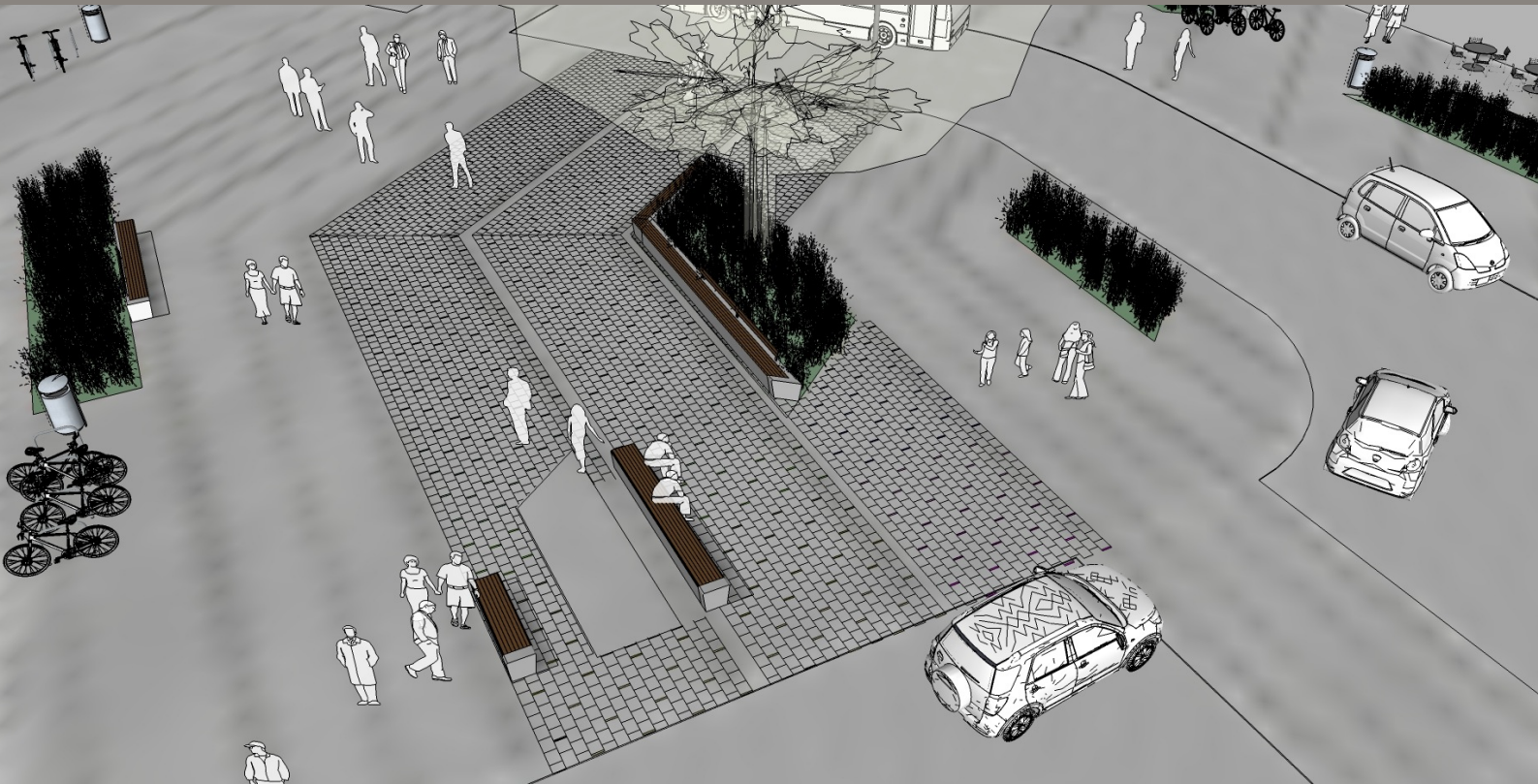

## Historical links to Darwin Green:

- 1873: William James Unwin started selling seeds as a side line to producing cut-flowers.
- His mother's family (Chiver) at this time started making Chivers jam.
- Alfred Unwin married Sarah Matilda ( nee Chivers in 1873) Alfred was farmer of 10 acres.
- 1900 : The National Sweet Pea Society based in Histon was formed.



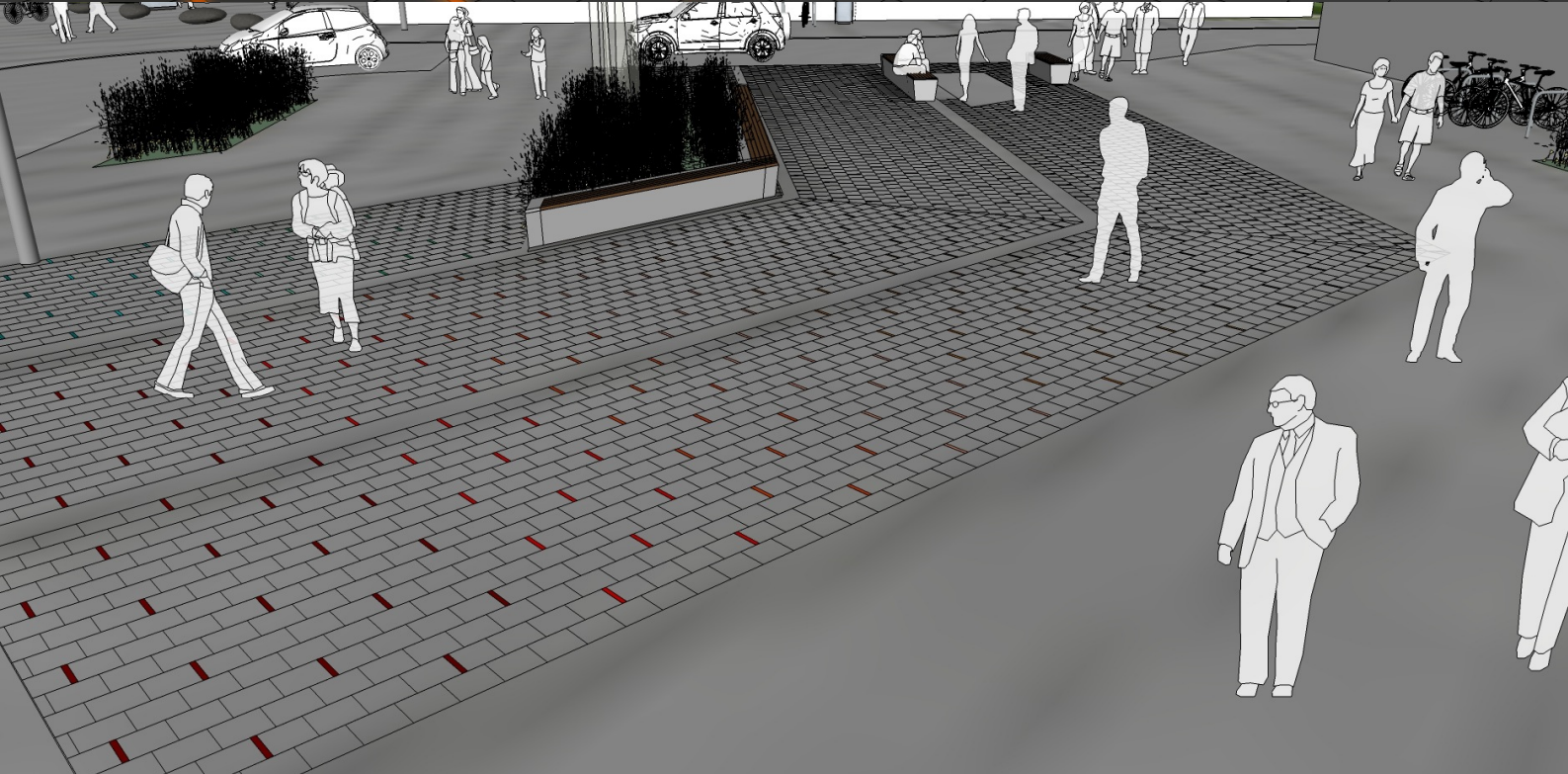
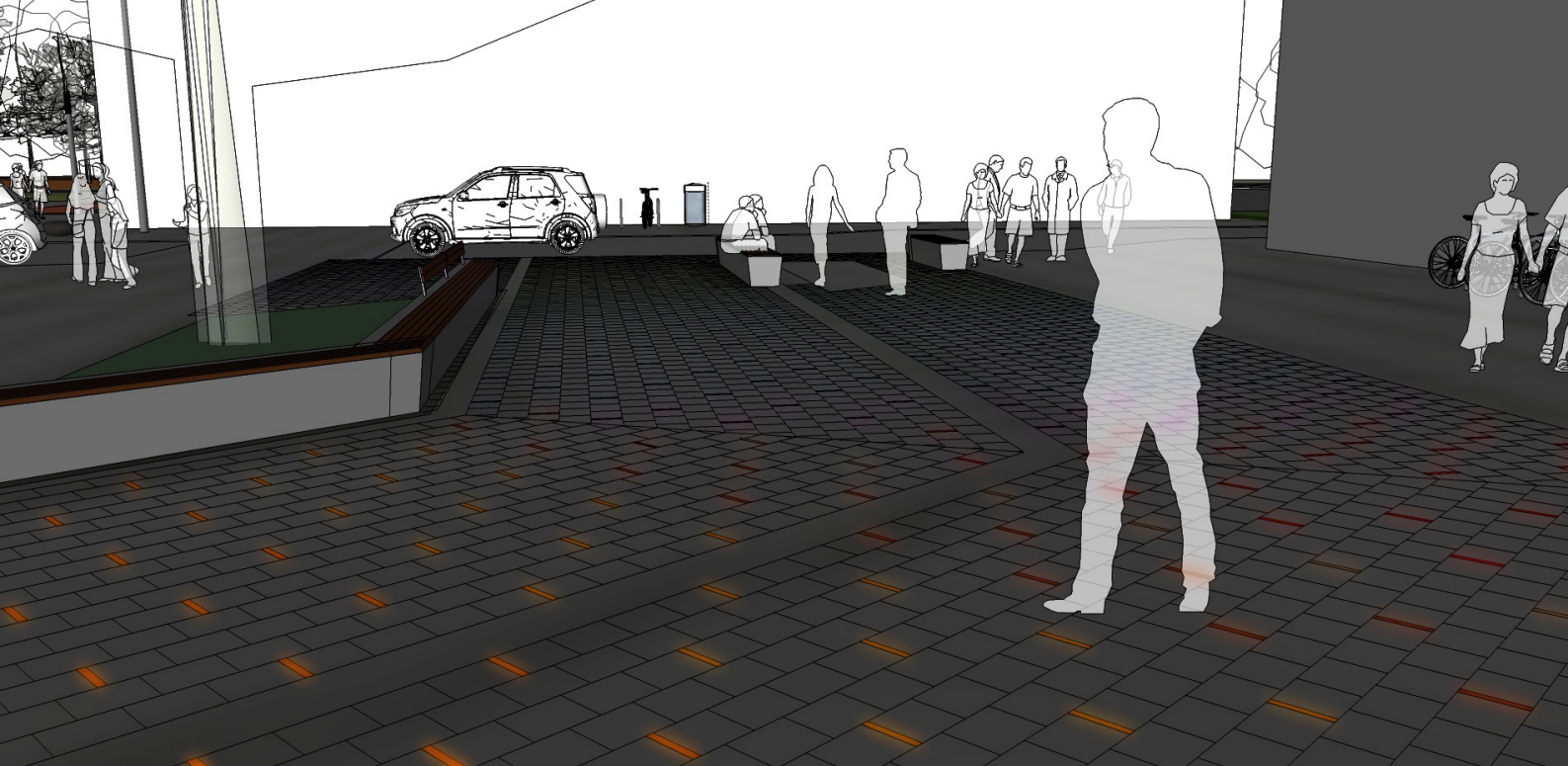

**Components:**

- 13 off UFO Fibre Optic Harnesses with 150 tail of sheathed 2mm fibre fitted with M10 nickel plated ferrules, all tails terminated in a polished 30mm mini common end –average tail lengths 15m
- 1 off UFO Fibre Optic Harnesses with 50 tail of sheathed 2mm fibre fitted with M10 nickel plated ferrules, all tails terminated in a polished 30mm mini common end – average tail lengths 15m
- 14 off Sirius High output LED light source, white light only with 5500k colour temperature.
- 2000 off UFO P3N stainless steel paver fittings, 316 stainless steel with special Lee colour filters – colours to be confirmed by Mackinnon Day

